



**Replacement Part | Specification**

Model (SKU)

**PT100-507**

PermaTile™ Series Rough-In Round Tile Wall Anchor

**Applicable Features & Installation Types**

- Stainless steel construction with protective thumb screw
- Mortar-based installation system (No mastic or organic adhesives allowed)
- Wall anchor configured specifically for TileWare accessories
- Refer to installation instructions before use
- Tested by TCNA
- BUY US ONCE FOR LIFE



**For Tile**

**T**

Tile Thickness Range  
5/32" – 1/2" (4mm – 13mm)

- Promessa™ Series
  - Baskets
    - T101-111
    - T101-112
    - T101-211
    - T101-212
    - T101-311
    - T101-312

**Mates with Trim Only**

**TX**

Tile Thickness Range  
5/32" – 1/2" (4mm – 13mm)

- Promessa™ Series
  - Baskets
    - TX101-111
    - TX101-112
    - TX101-211
    - TX101-212
    - TX101-311
    - TX101-312



p: 828-322-9273 | f: 828-304-1076  
tilewareproducts.com | info@tilewareproducts.com

page 1 of 2  
TW-F02-205-PT100 | REV: 8-12-20



### Replacement Part | Specification

Model (SKU)

**PT100-507**

PermaTile™ Series Rough-In  
Round Tile Wall Anchor

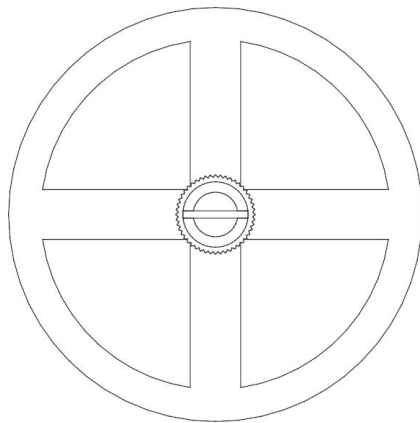

**3/4" [19.3mm]**

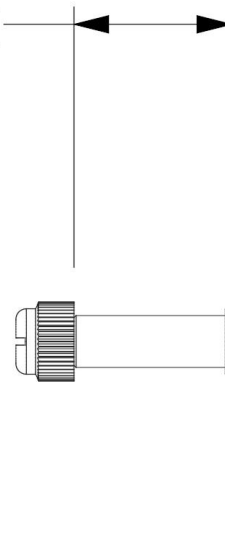

**1/32" [1mm] (20GA)**

**Product Dimensions** (units are in both inches and mm)

**Weight**

0.027 lb / 0.012 kg

250



p: 828-322-9273 | f: 828-304-1076  
tilewareproducts.com | info@tilewareproducts.com

page 2 of 2  
TW-F02-205-PT100 | REV: 8-12-20