



**TILEWARE**  
PRODUCTS



**MORTAR BASED INSTALLATION SYSTEM – NO MASTIC**

Promessa™ Series Toilet Tissue Holder

Revised: 11/15/17

Installation Procedures For The Following Models:

**Model T105-011**

**Toilet Tissue Holder (Contemporary)**



T105-011-PC



T105-011-BN

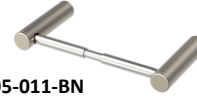

T105-011-ORB

**Model T105-012**

**Toilet Tissue Holder (Traditional)**



T105-012-PC

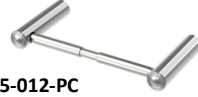

T105-012-BN

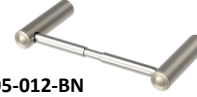

T105-012-ORB

## STEP 1 Understand Fastener

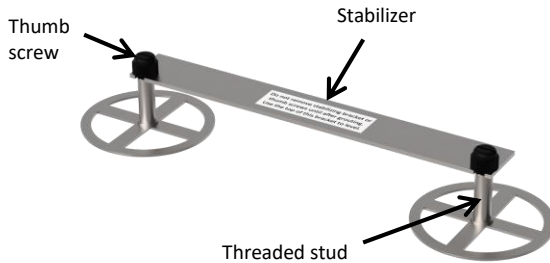

- Each PermaTile™ Fastener is equipped with a stabilizing bracket. The bracket ensures that Toilet Tissue Holder mounts properly. Remove stabilizer after thin-set has met minimum cure times specified by manufacturer.

**Warning:** Each threaded stud is covered with a plastic thumb screw to prevent thin-set mortar from corrupting thread. Do not remove until after grouting.

## STEP 2 Determine Toilet Tissue Holder Location

- Determine the wall surface where the PermaTile™ Fastener should be located.
- Apply thin-set mortar with no less than a 1/4" x 3/8" notch trowel.

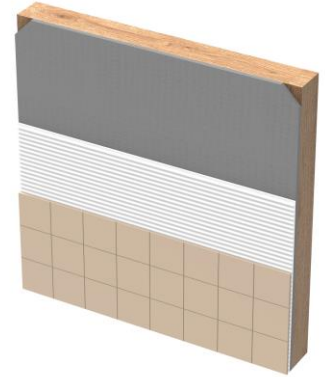

**Note:** System will not work on tile thicknesses less than 5/32" or greater than 1/2"

## STEP 3 Install PermaTile™ Fastener

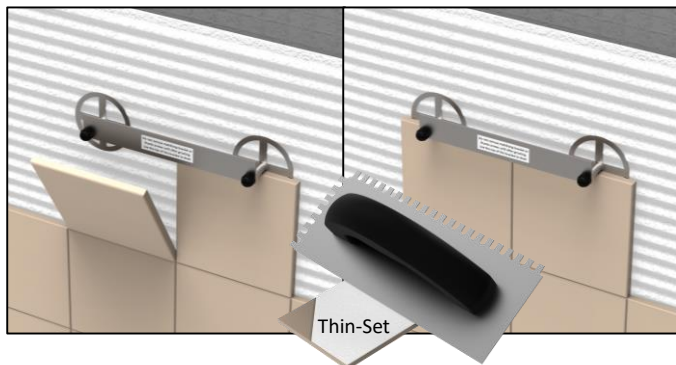

- Key thin-set mortar into the back side of tile to ensure proper contact and adhesion.
- Press the PermaTile™ Fastener into the combed thin-set mortar at the predetermined location.
- Adjust as necessary, setting stud directly on tile edge.

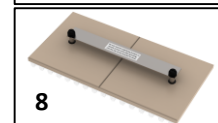
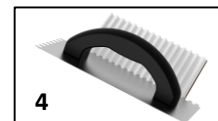
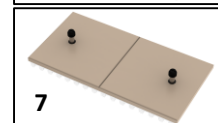
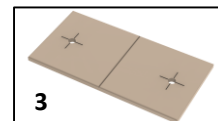
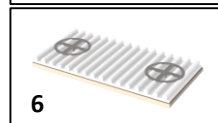
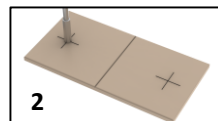
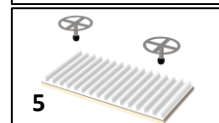
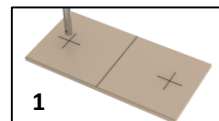

## STEP 4 Mark & Notch Tiles

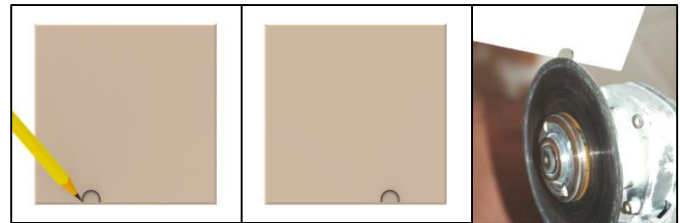

- Mark notch location.
- Carefully remove stabilizing bracket marking left & right side notch locations.
- Using an angle grinder, remove enough material allowing 1/16" of adjustment side to side and up and down.

**Warning:** Notches and holes should not exceed 3/8" in diameter to ensure trim has sufficient surface area during mounting.

### Technical Fact:

Procedures for installing PermaTile™ Fastener in the body of the tile. Use only 10mm diamond drill bit (core). Use Stabilizer as drilling template.



## Promessa™ Series Toilet Tissue Holder Installation Procedures For T105-011 & T105-012

### STEP 5 Install Notched Tiles

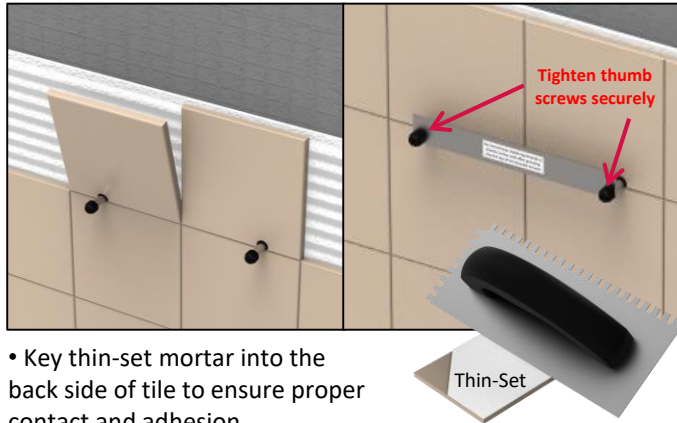

- Key thin-set mortar into the back side of tile to ensure proper contact and adhesion.
- Press tile into wall and adjust as necessary.
- Remount stabilizer as shown, make sure it fits freely, then **tighten thumb screws securely**.
- Proceed with tile installation.

**Warning:** Do not proceed with accessory installation until thin-set mortar has met minimum curing requirements specified by manufacturer.

**Not using stabilizer will result in toilet tissue holder mounting failure**

### STEP 6 Mount Left & Right Side Sleeve



- Remove plastic thumb screws & stabilizer after grouting.
- Starting on left side, simply slip sleeve over threaded stud, insert 8-32 stainless steel screw and attach.
- Using a #2 phillips head screwdriver, attach screw firmly to tile wall.

### STEP 7 Mount Tissue Holder

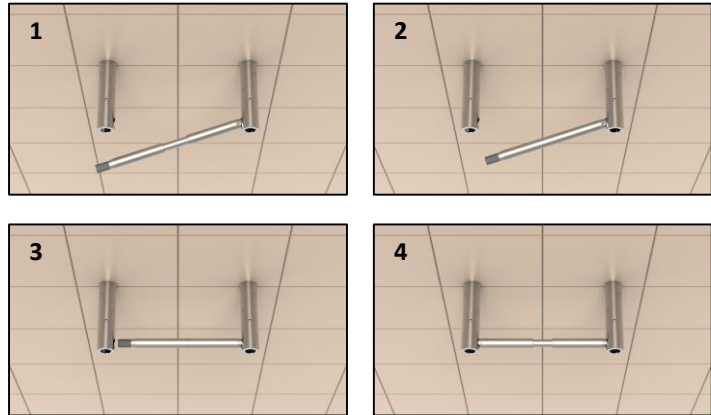

1. Insert tissue holder assembly into attachment hole of right sleeve.
2. Compress tissue holder assembly.
3. Position tissue holder assembly so that left side is in line with attachment hole of left sleeve
4. Once tissue holder assembly is in line with left sleeve, simply release tension, allowing tissue holder to spring in place.

### STEP 8 Attach Caps

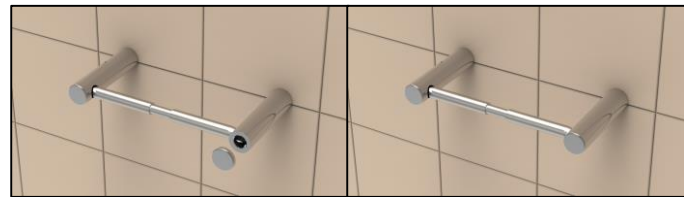

- Thread on caps.
- Installation complete

***Thank you for using our products!***

**TileWare Products**  
PO Box 793, Hickory, NC 28603  
Technical Support: 828-322-9273  
Email: [info@tilewareproducts.com](mailto:info@tilewareproducts.com)  
[www.tilewareproducts.com](http://www.tilewareproducts.com)

## Toilet Tissue Holder Parts List

Model	Fastener Assembly quantity 1 per kit	Sleeve quantity 2 per kit	Tissue Holder quantity 1 per kit	Cap quantity 2 per kit	8-32 Screw quantity 2 per kit
T105-011 or T105-012	PT100-516 	C232-001 	A230-001 	C232-005 or C232-012 Contemporary - Traditional 	C200-013 