



Promessa™ Series Toilet Tissue Holder

Revised: 8/20/18

Installation Procedures (Gypsum Wallboard/Drywall Surfaces)

Model G105-011 Toilet Tissue Holder (Contemporary)



G105-011-PC

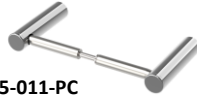

G105-011-BN

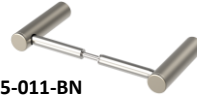

G105-011-ORB

Model G105-012 Toilet Tissue Holder (Traditional)



T105-012-PC

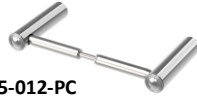

T105-012-BN



G105-012-ORB

STEP 1 Insert Blocking

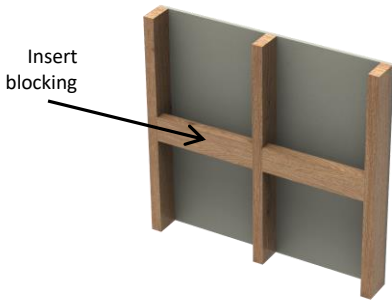

• Insert no less than 2" x 4" wood blocking or locate in vertical stud.

Warning: FASTENER SYSTEM ONLY WORKS WITH WOOD BLOCKING

(DO NOT USE WALL ANCHORS WITH THIS SYSTEM)

STEP 2 Locate Wood Blocking

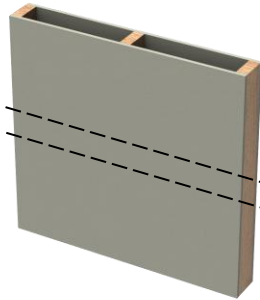

STEP 4 Pre-drill 3/8" holes

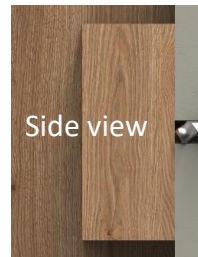
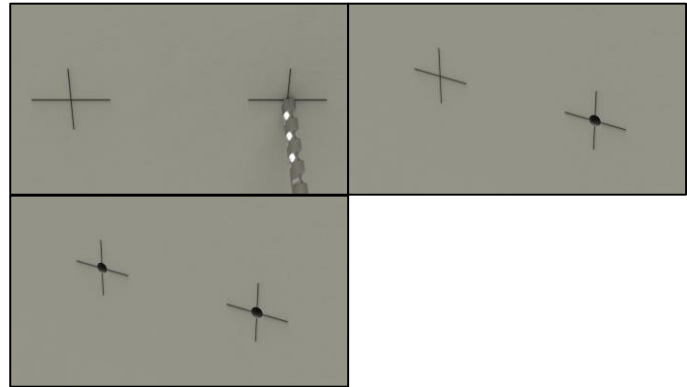

Side view

Warning: Do not drill deeper than the thickness of gypsum wallboard (drywall) material.

STEP 3 Create Level Lines

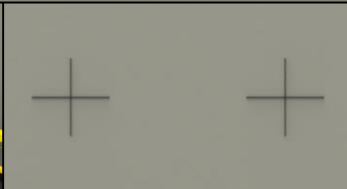
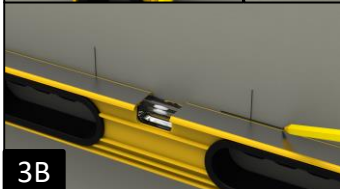
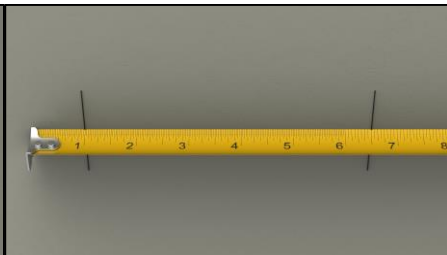
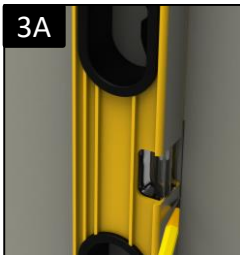
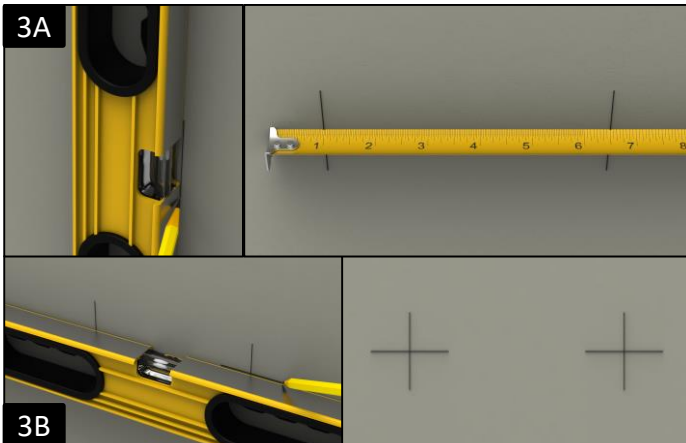

• Pre-drill a 3/8" hole (right and left sides) in gypsum wallboard (drywall) to accommodate spacer in step 5. Place some tape on the drill to mark drill depth. (Example: If wallboard material is 1/2" thickness, only drill to that depth. Do not drill into wood blocking). See 'Side view' diagram above.

STEP 5 Insert Spacers

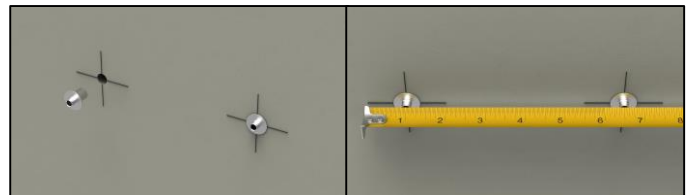

Technical Fact:

Spacer prevents gypsum wallboard (drywall) from collapsing at drilled hole. Additionally, protects from over-tightening screw which can draw the accessory into the gypsum wallboard (drywall) material.

• As illustrated in 3A - Use a level to determine position of right spacer and mark a vertical line. Measure precisely 5-1/2" from this line to locate the position of left spacer.

• As illustrated in 3B - Repeat the process above horizontally.



TILEWARE
PRODUCTS



**FASTENER SYSTEM ONLY WORKS WITH WOOD BLOCKING
(DO NOT USE WALL ANCHORS WITH THIS SYSTEM)**

**For 1/2" GW
Materials Only**

Promessa™ Series Toilet Tissue Holder

Installation Procedures (Gypsum Wallboard/Drywall Surfaces)

STEP 6 Mount Left & Right Side Sleeve

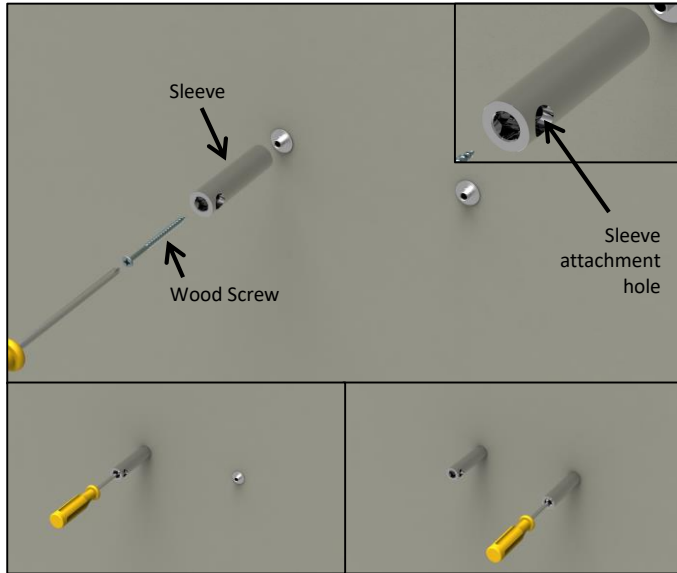

- Starting on left side, simply insert 2 1/2" wood screw through sleeve then into spacer. Using a #2 phillips head screwdriver, attach wood screw firmly to blocking (Sleeve attachment hole should be visible and facing to the right).
- When mounting the right sleeve, repeat the steps above (Sleeve attachment hole should be visible and facing to the left).

STEP 7 Mount Tissue Holder

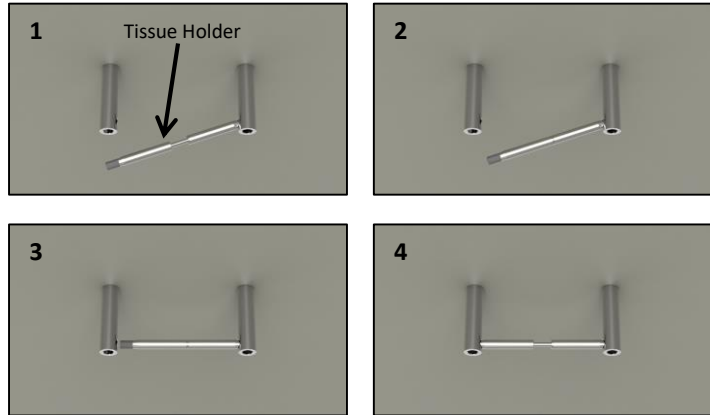

1. Insert tissue holder assembly into attachment hole of right sleeve.
2. Compress tissue holder assembly.
3. Position tissue holder assembly so that left side is in line with attachment hole of left sleeve
4. Once tissue holder assembly is in line with left sleeve, simply release tension, allowing tissue holder to spring in place.

STEP 8 Attach Caps

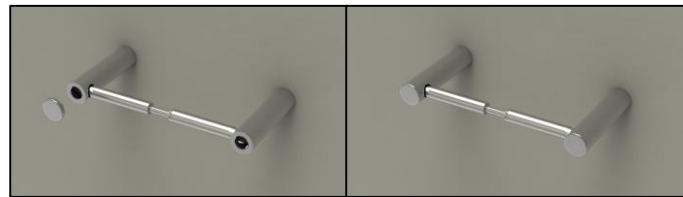

- Thread on caps.
- Installation complete

Thank you for using our products!

TileWare Products

PO Box 793, Hickory, NC 28603

Technical Support: 828-322-9273

Email: info@tilewareproducts.com

www.tilewareproducts.com

Toilet Tissue Holder Parts List

Model	Spacer quantity 2 per kit	Sleeve quantity 2 per kit	Tissue Holder quantity 1 per kit	Cap quantity 2 per kit	2-1/2" Wood Screw quantity 2 per kit
G105-011 or G105-012	C200-044 	C232-001 	A230-001 	C232-005 or C232-012 Contemporary - Traditional 	C200-041