

# PART SPECIFICATION SHEET

PART: A223-241

CODES / STANDARDS COMPLIANCE

**ADA**  
COMPLIANT



VICTORIA™ SERIES

COMBINATION 24" RADIUS GRAB BAR ( CONTEMPORARY )

MEETS OR EXCEEDS THE FOLLOWING AT DATE OF MANUFACTURE:

[ ALL INSTALLATION SYSTEMS ]

FINISHES: PC, BN, ORB

• ALL APPLICABLE US FEDERAL AND STATE MATERIAL REGULATIONS

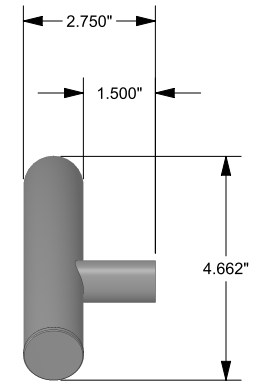
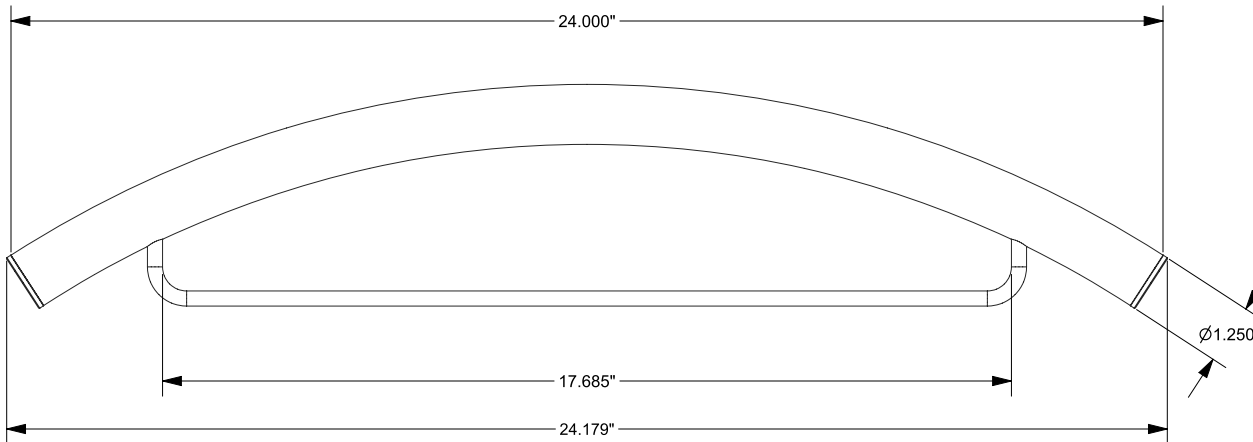
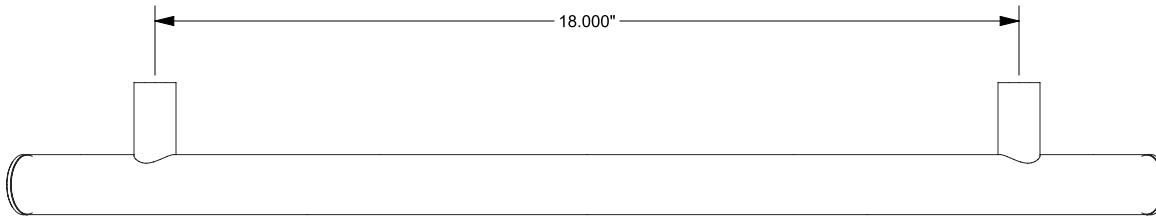
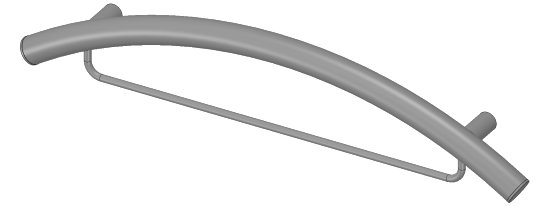

ERP PART #	A223-241	APPROVALS	DATE
DWG #	513	RLS	12/12/14
SHEET 1 OF 1	SCALE 1:4		
WEIGHT:	2.110 LB	CUBED:	8.070 IN <sup>3</sup>

TW-ENG4



**TileWare Products**  
www.tilewareproducts.com

Office (828) 322-9273 Fax (828) 304-1076