

PART SPECIFICATION SHEET

PART: PT100-515

PERMATILE™

'ROUGH-IN' ADA 36" GRAB BAR 'Z' FASTENER

PERMATILE™ 'ROUGH-IN' FASTENER FOR MATERIAL THICKNESSES FROM - 5/32" TO 7/8" ONLY
 FASTENERS CONFIGURED SPECIFICALLY FOR TILEWARE ACCESSORIES
 MORTAR-BASED INSTALLATION SYSTEM - NO MASTIC OR ORGANIC ADHESIVE ALLOWED!
 REFER TO INSTALLATION INSTRUCTIONS BEFORE USE

COMPATIBLE WITH LISTED MODELS

STAINLESS STEEL

- T200-031
- T200-032

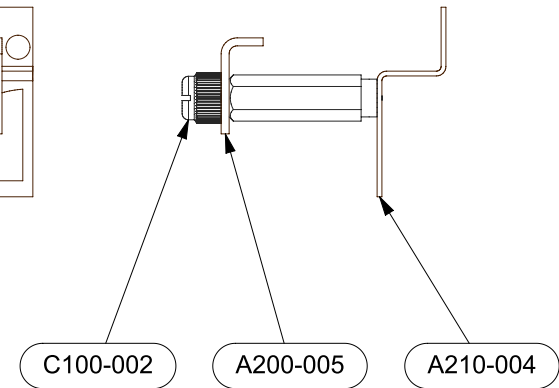
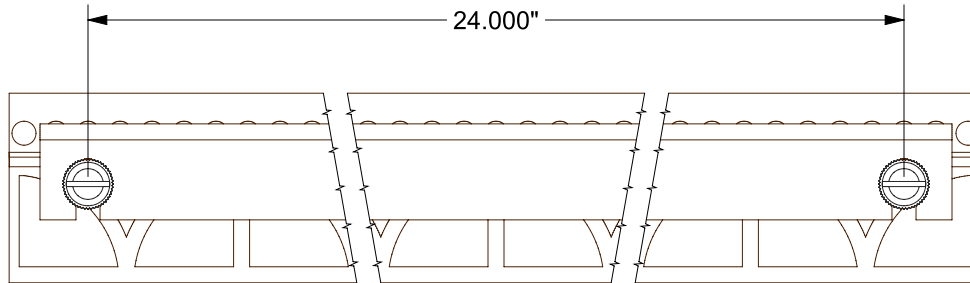
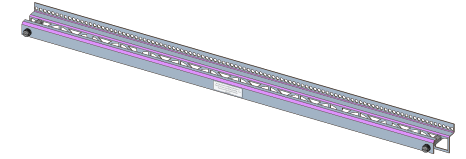

WORKS WITH ALL MATERIAL THICKNESSES

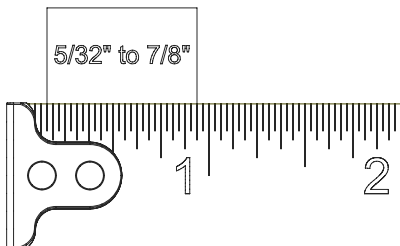

ERP PART #	REFERENCED ABOVE	APPROVALS	DATE
DWG #	358	RLS	7/31/14
SHEET 1 OF 1	SCALE 2:3		
WEIGHT:	0.824 LB	CUBED:	2.946 IN ³

TW-ENG9



TileWare Products
 www.tilewareproducts.com

Office (828) 322-9273 Fax (828) 304-1076